



37 Betjeman Close

Pinner, HA5 5SA

£270,000



37 Betjeman Close

Pinner, HA5 5SA

A spacious 2 double bedroom ground floor retirement flat well situated in this sought after development set within attractive landscaped gardens. The property benefits from a modern fitted kitchen, shower room, new carpets & floor coverings, double glazing, electric heating, emergency pull cords in all rooms and intercom. Resident estate manger, resident & visitor parking and a communal laundry room.

No upper chain, keys with agent.
Available to persons of 60 years of age and over.

Communal Front Door

Lobby

Own Front Door

Hallway

Living/Dining Room

Kitchen

Bedroom One

Bedroom Two

Shower Room

Outside

Communal Gardens

Resident & Visitor Parking

Communal Laundry Room

Lease - New 99 Year Lease

Service Charge - £3784 pa



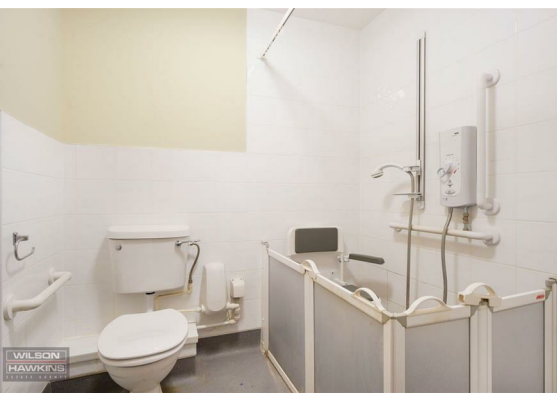

Ground Rent - £150 pa

Council Tax Band C

EPC Rating C

Floor Plan

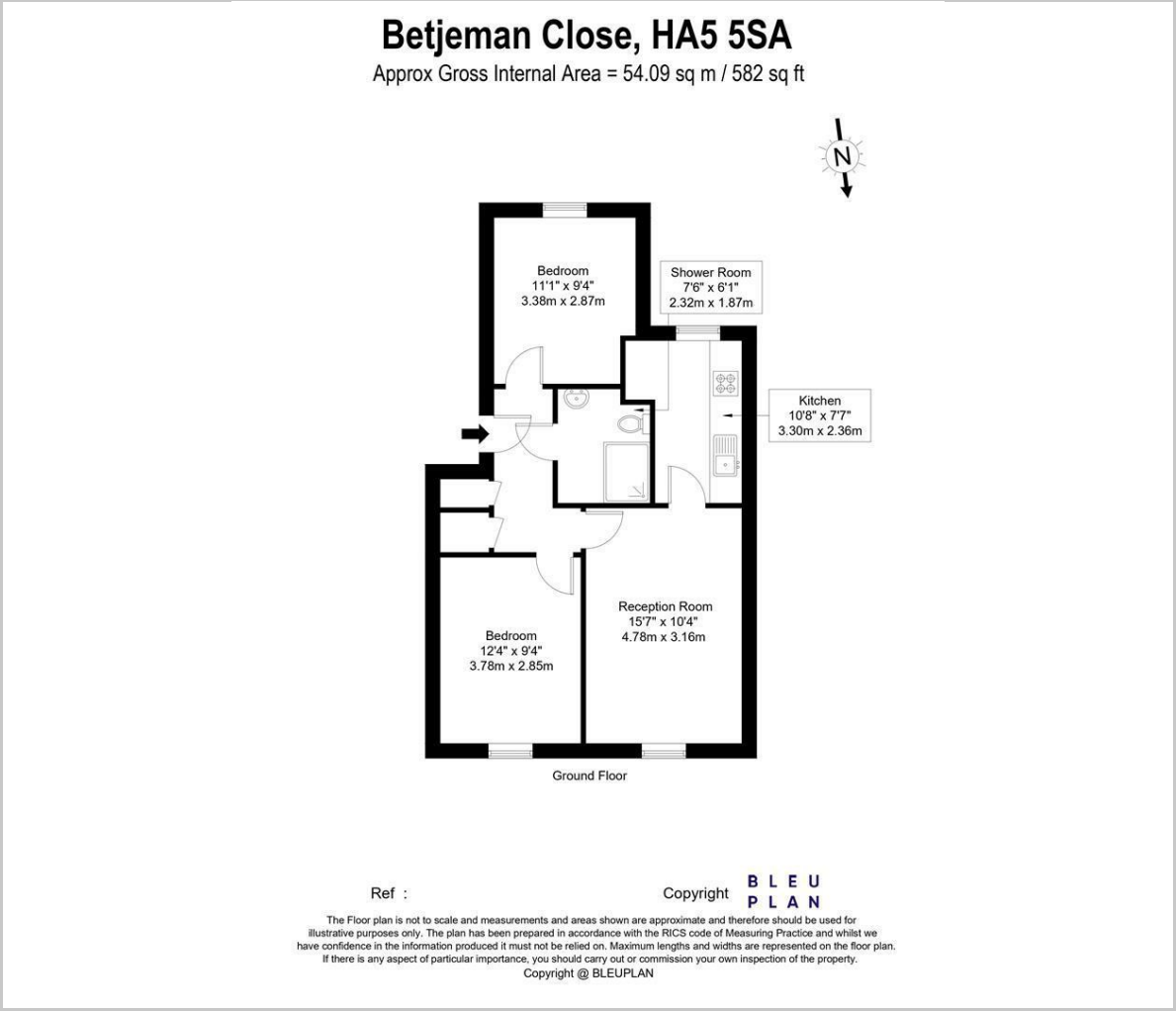

Viewing

Please contact our Harrow on the Hill Office on 020 8422 3333 if you wish to arrange a viewing appointment for this property or require further information.

Area Map

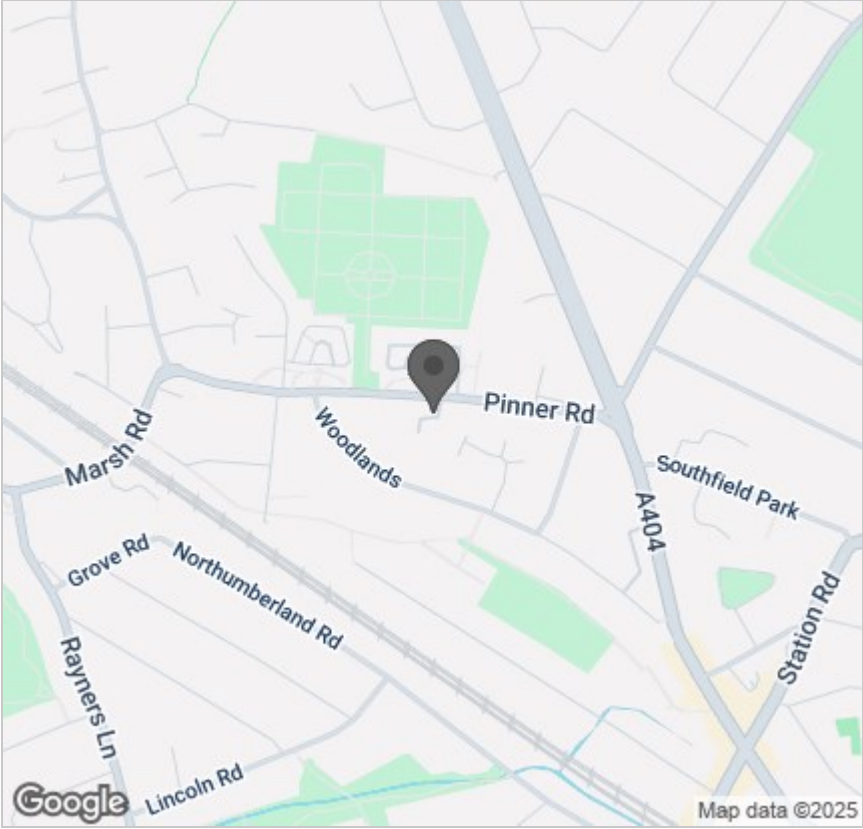

Energy Efficiency Graph

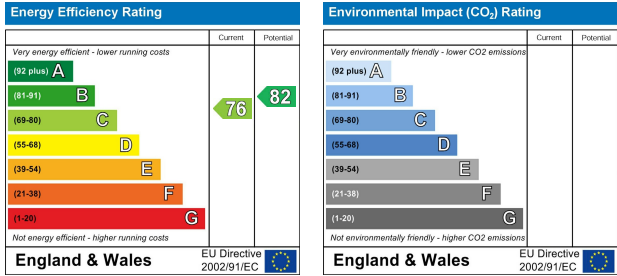

These particulars, whilst believed to be accurate are set out as a general outline only for guidance and do not constitute any part of an offer or contract. Intending purchasers should not rely on them as statements of representation of fact, but must satisfy themselves by inspection or otherwise as to their accuracy. No person in this firms employment has the authority to make or give any representation or warranty in respect of the property.

33-35 High Street, Harrow On The Hill, Harrow, Middlesex, HA1 3HT
Tel: 020 8422 3333 Email: enquiries@wilson-hawkins.co.uk www.wilson-hawkins.co.uk